

Teleque

T101

MK2 PTT Announcer

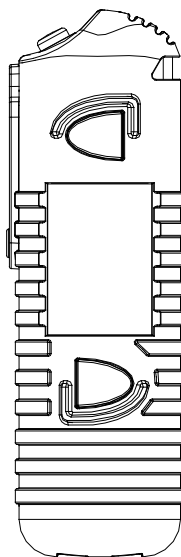
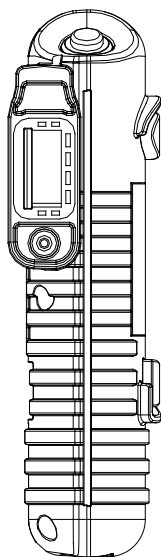

Product Manual



This product was designed and manufactured in the United Kingdom

All rights reserved
Copyright 2020 Teleque Ltd.

Information contained within this document is believed to be accurate however
Teleque Ltd. assumes no liability regarding its accuracy.

Teleque Ltd. reserves the to right to modify any product or literature without
prior notice or consent

Contents

Description.....	1
Operation.....	2
Specification.....	6
EC Declaration.....	7
Part Numbers.....	8
Warranty.....	9



Description

The T101 PTT Announcer is a rugged handheld microphone designed to work exclusively with the Teleque T101 Announcement Receiver, system designed specifically for railway station platform announcements.

The transmitter is housed in a rubber overmoulded ABS case and features a large PTT (push to talk) button for easy operation even with gloved hands. The set of frequencies embedded in the transmitter are associated with the platform numbers displayed on the unit's backlit LCD screen. These different frequencies are easily selected by pushing the large up or down buttons. When not operating the LCD is permanently enabled showing the currently selected channel.

The T101 has a high quality wide cardioid directional microphone - cutting down on both feedback and unwanted noise. The system's non-standard pilot tone prevents interference from any other RF sources meaning the receiver's mute circuitry will only open when it recognises the Teleque transmitter.

The unit's battery is a Lithium Ion rechargeable battery, giving up to 8 hours continual use. It is re-charged by placing in the Teleque TC101-2 charger, a 2 gang charger, designed to be wall or desk mounted.



Operation

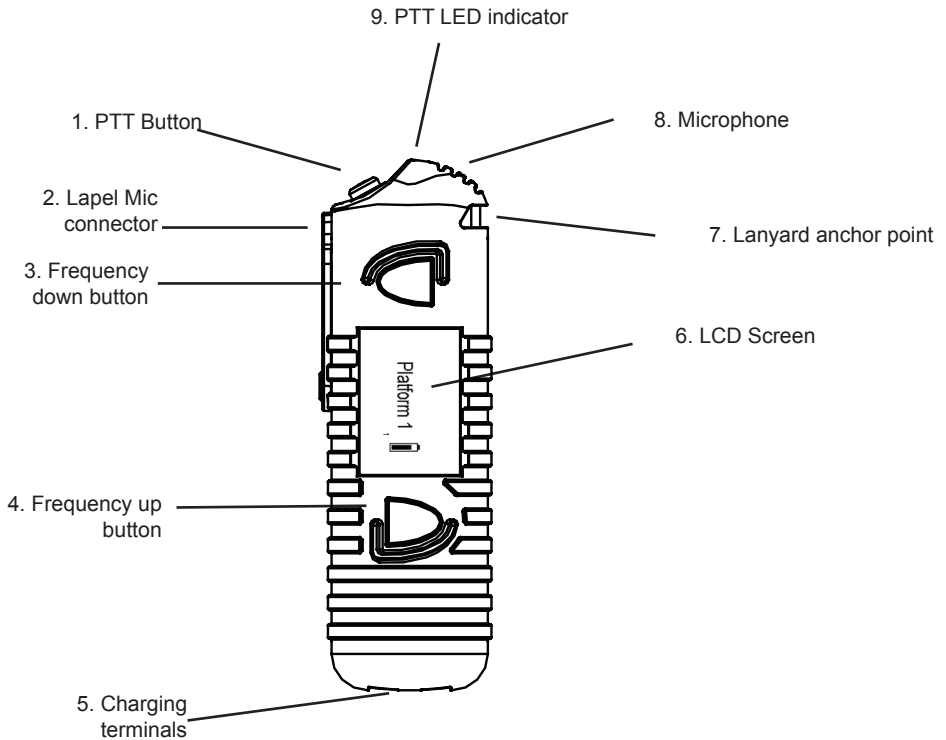

1. PTT Button

The Push to Talk (PTT) button is a large, easy to operate, red button. Once pushed, this illuminates the LCD backlight, the channel change buttons and the PTT LED indicator (item 8). The microphone is then operational, transmitting the RF signal on the channel indicated on the LCD screen. Once pushed speak directly into the microphone (item 7) keeping the microphone approx 5 cm from your mouth.

2&3 Frequency Up and Down Button

When the unit's frequency up and down buttons are pressed both the channel change buttons and the LCD backlight become illuminated. The display will then scroll through the possible operating frequencies shown by platform numbers. When activated this new operating frequency is put into memory as well as being the new frequency permanently displayed on the LCD .

The two buttons used are protected from inadvertent operation by both a rubber ridge surrounding the buttons and a delay before operation.

Please note : Changing the frequency does not enable the RF signal, this only happens when the PTT is operated.

4. Charging terminals

The charging terminals allow the unit's internal battery to be recharged. This is done using the Teleque TC101-2 charger. The transmitter has intelligent charger circuitry allowing full charge to be reached in approximately 3 hours, and then standby trickle charge thereafter.

5. LCD Screen

The LCD typically shows customer defined text relating to the 3 letter station designator and the zone the transmitter will broadcast to.

The operating RF channel and subtone of the transmitter is shown at the bottom right corner of the display, in the example shown below it is channel 7C.

The LCD also shows the current battery status in the form of a battery symbol as shown.

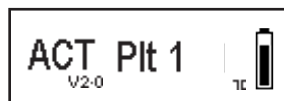

Battery Indication



Empty Battery



20% Battery



40% Battery



60% Battery



80% Battery



Full Battery

Note:

The T101 transmitter is powered by a Lithium Ion cell, as this is a rechargeable battery it should be charged for at least 3 hours before being used for the first time. A fully charged battery should last up to 8 hours with continual operation and more than 300 in standby mode. When not in use we recommend the T101 is left in the charger as this ensures reliable operation when required.

Charger Indication



When charging the transmitter the display shows an animation of the cell charging and displays the current status of the battery charge as a percentage. When the battery is fully charged the animation stops and 100% is displayed

6. Lanyard anchor point

A stainless steel pin allows connection to a suitable breakaway wrist strap or lanyard.

7. Microphone

The T101 has a high quality wide cardioid directional microphone which helps cut down both feedback and unwanted noise.

8. PTT LED Indicator

The PTT LED indicator is illuminated when the PTT button is pushed, it indicates to the user that the transmitter is operational and transmitting an RF signal.



Optional Extras

Lapel Microphone -T101/70/TX/LM

The lapel microphone has an integral Push-To-Talk (PTT) switch. It connects to the T101/70/A Adaptor via a High quality Hirose connector. The transmitter can then be mounted on a belt with the T101/70/TX/BC beltclip.

The Lapel mic option is ideal for applications where the transmitter is shared between many staff members as each member of staff can have their own personal microphone, helping to avoid Covid19 viral transmission .

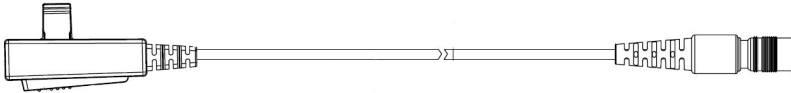

Lapel Microphone Adaptor - T101/70/TX/A

The adaptor has a high quality Hirose connector to connect to the lapel microphone, it then connects to a gold plated pad array on the transmitter retained with a UNC screw. It is designed to be robust and allow multiple connections to the Lapel microphone, without having undue wear to the transmitter connection. This allows periodic replacement of the adaptor.

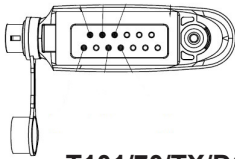

Transmitter dust Cover - T101/70/TX/DC

If the operator chooses not to use the lapel mic option the gold plated pad array should be always covered with the T101/70/TX/DC dust cover.

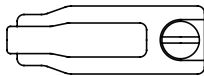

Transmitter Belt Clip T101/70/TX/BC

The transmitter can have a belt clip mounted on its rear panel.

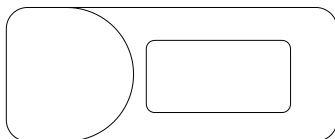

SPECIFICATION

Operating Frequencies

Channel	Frequency	Channel Code	Sub Tone
1	863.050 MHz	1	A-F
2	863.700 MHz	2	A-F
3	864.175 MHz	3	A-F
4	864.500 MHz	4	A-F
5	864.925 MHz	5	A-F
6	863.350 MHz	6	A-F
7	863.900 MHz	7	A-F
8	864.375 MHz	8	A-F
9	864.700 MHz	9	A-F
10	863.550 MHz	10	A-F
11	864.025 MHz	11	A-F
12	864.650 MHz	12	A-F
13	864.325 MHz	13	A-F
14	864.975 MHz	14	A-F
15	863.925 MHz	15	A-F
16	Test	16	A-F

(Other frequencies available on request)

RF

Effective Radiating Power (ERP)	-	10 mW
Audio Frequency Response	-	200 Hz – 10 kHz
Antenna	-	Internal dipole
Grid Spacing	-	25 kHz
Pilot Tone Frequency	-	32.718 kHz

Battery

Type	-	Internal Lithium Ion
Talk Time	-	Up to 8 hours
Life Time	-	Up to 3 years
Life Cycle	-	>1000
Quiescent battery life	-	Up to 300 hours

General

Material	-	ABS/PC with rubber overmould
Colour	-	Black

Environmental

Temperature (storage and operating)	-	-10 °C to +50 °C
Humidity Range (non-condensing)	-	0% to 93%

Dimensions and Weight

Dimensions	-	Height :	148 mm
		Width :	43 mm
		Depth :	30 mm
Weight	-	-	120 g

EC DECLARATION OF CONFORMITY TO R&TTE DIRECTIVE 1995/5/EC

Manufacturer:	Teleque
Representative for Distribution:	
Product:	Teleque T101 Wireless communicator Handheld Transmitter and Fixed Receiver.
Conformity Assessment:	Annex III - Internal Production Control plus Specific Apparatus Tests.
Notified Bodies used:	None
Certificate:	not applicable
Other applicable directives:	None

Reference standards used for presumption of conformity:

Article 3.1a EN 60065:2002, A1:2006
Article 3.1b EN 301 489-9 v1.4.1
Article 3.2 EN300_422-2_v1.3.1_
Article 3.3 EN50121-4

Declaration

We, Teleque Ltd, declare under our sole responsibility that the essential radio test suites have been carried out and that the above product to which this declaration relates is in conformity with all the applicable essential requirements of EU Directive 1995/5/EC



London 1st July 2011

Mr Richard Ganley. Head of R&D

Railway Specific Approvals

PADS Certified:

PA05/05898



Teleque Part Numbers

Single Receiver in wall mount IP65 steel case	T101/70/RXWM
Single Receiver unit in 19" 1U Rack Mount Format	T101/70/RX 19
Dual Receiver unit in 19" 1U Rack Mount Format	T101/70/Dual RX
Receiver Active Directional Antenna in IP65 enclosure	TDP101/70/DAIP65
Transmitter <ul style="list-style-type: none"> - Beltclip - Dustcover - Flush gold grid array - 6 pin Hirose Adaptor with PTT - Personal push-to-talk lapel microphone - Personal push-to-talk headworn microphone 	T101/70/TX T101/70/TX-BC T101/70/TX-DC T101/70/TX/APTT T101/70/TX/LM1 T101/70/TX/HM1
Standalone 2 Gang charger c/w 100-230VAC adaptor.	TC101-2
Antenna Distribution Amplifier & PSU for 4 x RX	ADU2-4/PS
Receiver 230V mains operated power supply	T101/110-230V/PS
Receiver Active Directional Antenna Bracket	T101/DAIP65/BRT
2 way passive antenna splitter/combiner with selectable DC coupling	PSA201
Receiver polling and aux switching unit mounts into 19" dual RX case (PCB only)	P101/2/PCB
Receiver polling and aux switching unit mounted in 19" dual RX case	P101/2/SA

Standard Limited Warranty

Teleque warrants that the Equipment shall be free from defects in materials or workmanship during the Warranty Period. The Warranty Period is ONE (1) YEAR from the date of purchase by the original end-user customer.

Subject to the exclusions detailed below, if the Equipment fails to conform to this Warranty and the purchaser notifies Teleque in writing within the Warranty Period, Teleque shall, without charge for labour or parts, (in its sole discretion), repair or replace the Equipment on the terms and conditions set out below.

Exclusions

The following are excluded from warranty:

Damage caused by:

- Misuse, including (but not limited to) failure to use the Equipment for its normal purpose in accordance with Teleque's instructions on its proper use and maintenance;
- Improper operation or maintenance of the Equipment;
- Connection to improper power supply; attempted repair by anyone other than a properly Teleque authorized service agent;
- Use of the Equipment in conjunction with third party accessories, products or ancillary peripheral equipment.
- Equipment where the manufacturer's serial number has been altered, deleted, removed, or made illegible.
- Equipment which has been adjusted or adapted without Teleque's prior written consent, including (but not limited to): upgrading the Equipment beyond specifications or features described in the instruction manual, or modifications to the Equipment to conform it to national or local technical or safety standards in countries other than those for which the Equipment was specifically designed and manufactured.
- Normal wear and tear of parts, as defined by Teleque for example in Service Manuals, unless there is evidence of a manufacturing defect.
- Costs associated with de-installation, re-installation or integration into a system
- Acts of God or any reason beyond Teleque's reasonable control;

THE EXPRESS WARRANTY ABOVE SHALL BE THE FULL EXTENT OF TELEQUE'S LIABILITY. ACCORDINGLY, TELEQUE DISCLAIMS ALL OTHER LIABILITY FOR LOSS OR DAMAGE HOWSOEVER CAUSED (EXCEPT FOR DEATH OR PERSONAL INJURY RESULTING FROM PROVED NEGLIGENCE)

Teleque Ltd.
www.teleque.co.uk

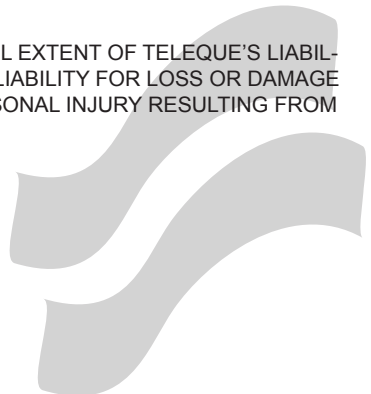



Teleque Ltd.
www.teleque.co.uk